

REV	LOCATIONS	DESCRIPTION	DATE	REVISER	APPD

SPECIFICATIONS

Electrical

Current Rating: 1A AC(rms)/DC
Voltage Rating: 250V AC(rms) 500V DC
Contact Resistance: 35 mΩ Max
Insulation Resistance: 500 MΩ Min
Withstanding Voltage: 500V AC r.m.s
Temperature Range-Operating: -40°C~+105°C

Material and Plating

Housing: PBT (UL 94V-0), Black
Contact: Copper Alloy/ Selective gold in contact area, tin on tail
Shell: Zinc Alloy/ Nickel plated

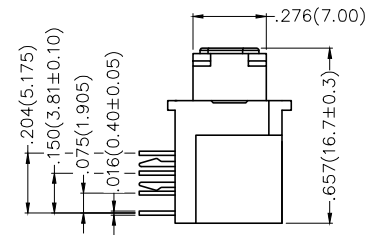

Ordering Information

FCS 100 07 - F0 D B 3 XX K6 K A
1 2 3 4 5 6 7 8 9 10 11

Recommended P.C.Board Layout
General Tolerances: ±0.05mm

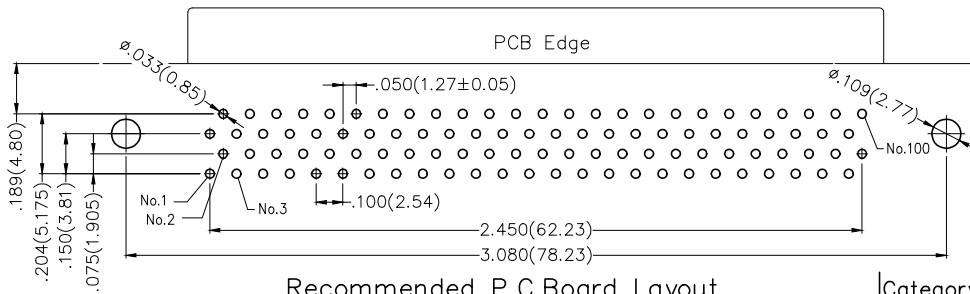

1	Category	2	Circuits	3	Distinction No.	4	Type	5	Assembly Layout	6	Entry Angle
	FCS-SCSI		100		07		F0-Female		D-DIP		B-90° Angle
7	Plating	8	Thickness of Plating	9	Color-Resin	10	Packaging	11	Contact Position		
	3-Selective gold in contact area, tin on tail		00-Gold flash 03-3μ" Custom plate available		K6-Black		K-Tray		A-Positive Needle		

 THIRD ANGLE PROJECTION	GENERAL TOLERANCES (UNLESS SPECIFIED)		APPROVE BY	DATE	PART NO.	ITEM NO.	 Leader Of Industry	
	X.±.012(0.30)	X.'±5'	FRANK	19/OCT/15	FCS10007-F0DB3XXK6KA	FCS10007		
	DESIGN UNITS Inch (metric)	X.X±.008(0.20)	X.'±2'	CHECKED BY	DATE	TITLE		REV 0 SHEET NO. 1/2
	SCALE	X.XX±.006(0.15)	.XX'±1'	CHERRY	19/OCT/15	SCSI Connector Pitch 1.27mm 180° Vertical Female		
SIZE	X.XXX±.004(0.10)	.XXX'±0.5'	DRAWN BY	DATE	THIS DRAWING CONTAINS INFORMATION THAT IS PROPRIETARY TO TXGA INDUSTRIAL ELECTRONICS(S.Z)CO.,LTD AND SHOULD NOT BE USED WITHOUT WRITTEN PERMISSION			
5:1	A4		KATE	19/OCT/15				

REV	LOCATIONS	DESCRIPTION	DATE	REVISER	APPD

SPECIFICATIONS

Electrical

Current Rating: 1A AC(rms)/DC
Voltage Rating: 250V AC(rms) 500V DC
Contact Resistance: 35 mΩ Max
Insulation Resistance: 500 MΩ Min
Withstanding Voltage: 500V AC r.m.s
Temperature Range-Operating: -40°C~+105°C

Material and Plating

Housing: PBT (UL 94V-0), Black
Contact: Copper Alloy/ Selective gold in contact area, tin on tail
Shell: Zinc Alloy/ Nickel plated

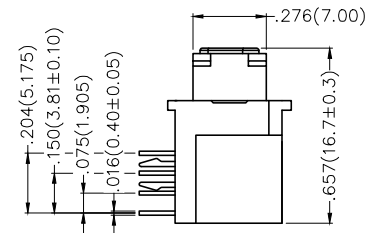

Ordering Information

FCS 100 07 - F0 D B 3 XX K6 K B
1 2 3 4 5 6 7 8 9 10 11

Recommended P.C.Board Layout
General Tolerances: ±0.05mm

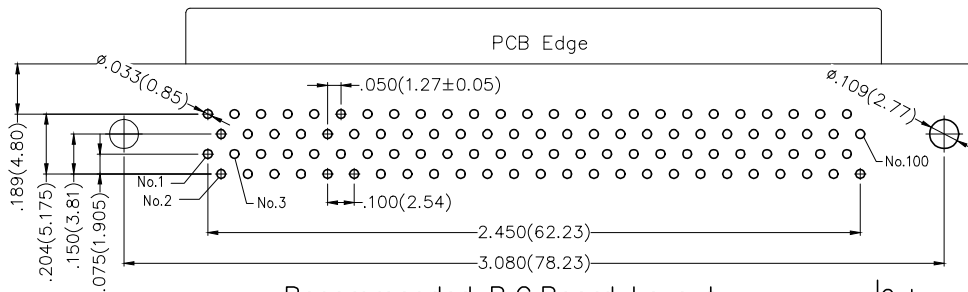

1	Category	2	Circuits	3	Distinction No.	4	Type	5	Assembly Layout	6	Entry Angle
	FCS-SCSI		100		07		F0-Female		D-DIP		B-90° Angle
7	Plating	8	Thickness of Plating	9	Color-Resin	10	Packaging	11	Contact Position		
	3-Selective gold in contact area, tin on tail		00-Gold flash 03-3μ" Custom plate available		K6-Black		K-Tray		B-Versa Needle		

 THIRD ANGLE PROJECTION	GENERAL TOLERANCES (UNLESS SPECIFIED)		APPROVE BY	DATE	PART NO.	ITEM NO.	 Leader Of Industry
	X.±.012(0.30)	X'.±5'	FRANK	19/OCT/15	FCS10007-F0DB3XXK6KB	FCS10007	
DESIGN UNITS Inch (metric)	X.X±.008(0.20)	X'.±2'	CHECKED BY	DATE	TITLE		REV 0 SHEET NO. 2/2
SCALE	X.XX±.006(0.15)	.XX'±1'	CHERRY	19/OCT/15	SCSI Connector Pitch 1.27mm 180° Vertical Female		
SIZE	X.XXX±.004(0.10)	.XXX'±0.5'	DRAWN BY	DATE	THIS DRAWING CONTAINS INFORMATION THAT IS PROPRIETARY TO TXGA INDUSTRIAL ELECTRONICS(S.Z)CO.,LTD AND SHOULD NOT BE USED WITHOUT WRITTEN PERMISSION		
5:1			KATE	19/OCT/15			